

Delvo

ELECTRIC SCREW-DRIVER

DLV7321-CKE/CKE B(6P BIT-EARTH)/BKE
 DLV7331-CKE/CKE B(6P BIT-EARTH)/BKE
 DLV7325-CKE/CKE B(6P BIT-EARTH)/BKE
 DLV7335-CKE/CKE B(6P BIT-EARTH)/BKE

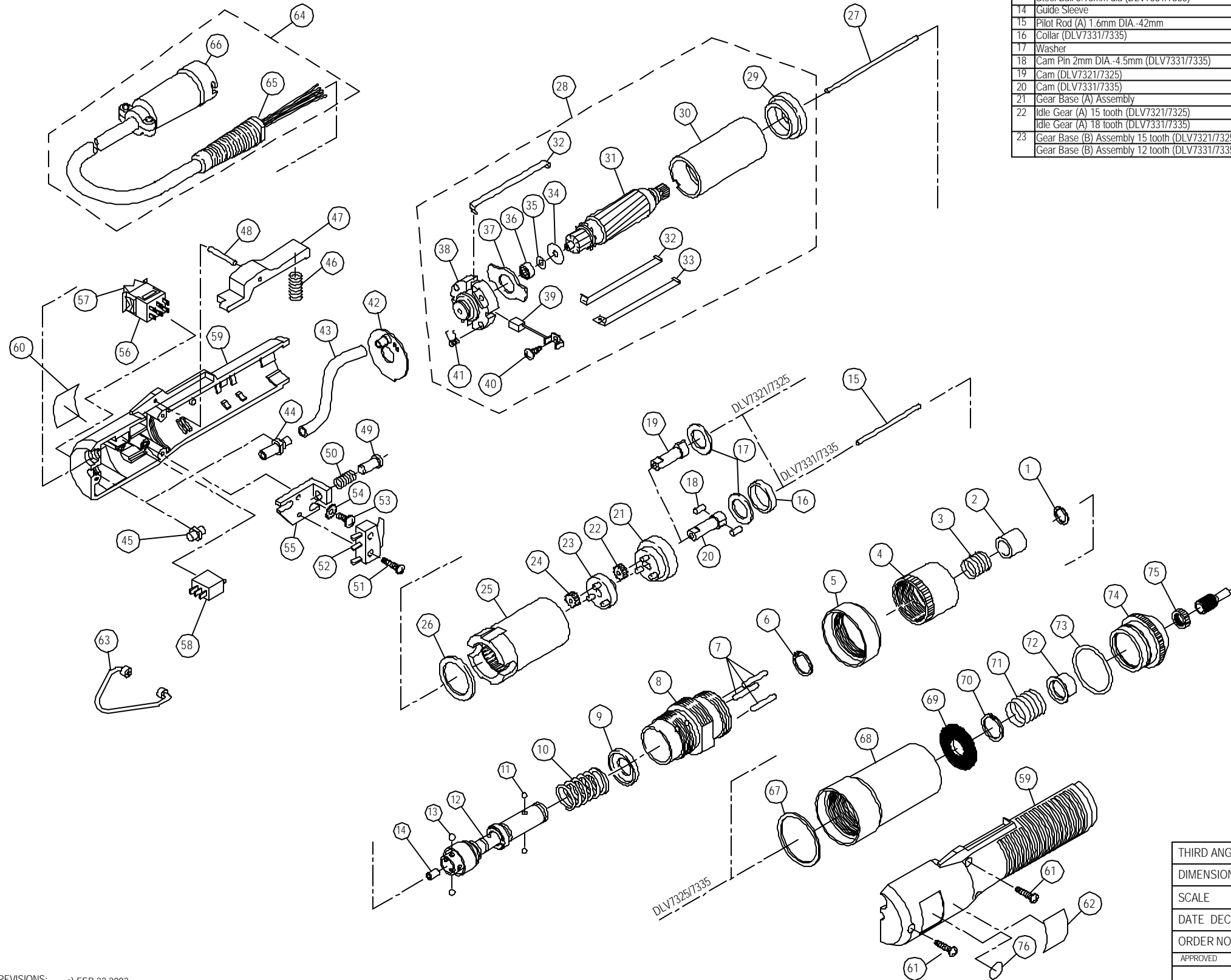

No.	Parts Name	Parts No.	Qty	(Parts No.)	No.	Parts Name	Parts No.	Qty	(Parts No.)
1	Stop Ring	TV00149	1	5462316K	24	Idle Gear (B) 15 tooth (DLV7321/7325)	TV00003	3	5460408K
2	Holder Clamp	TV00148	1	5462304K		Idle Gear (B) 18 tooth (DLV7331/7335)	TV00004	3	5460409K
3	Holder Spring	TV00277	1	5462317K	25	Gear Case 45 tooth (DLV7321/7325)	TV00028	1	5460281K
4	Spring Adjusting Ring	TV00055	1	5460471K		Gear Case 48 tooth (DLV7331/7335)	TV00029	1	5460282K
5	Coupling (DLV7321/7331)	TV00011	1	5460419K	26	Spacer	TV00102	1	5460440K
6	Stop Ring	LP10494	1	5462712K	27	Pilot Rod 1.6mm DIA.-61.5mm	TV00077	1	5460441K
7	Roller Pin 2mm DIA.-19.8mm (DLV7321/7325)	TV00510	3	5460753K	28	Motor Assembly (DLV7321/7325-CKE/CKE B)	TD00531	1	5460486A
8	Roller Pin 2mm DIA.-17.8mm (DLV7331/7335)	TV00109	3	5462735K		Motor Assembly (DLV7321/7325-BKE)	TD02210	1	5460486B
9	Nose Nut	TV00577	1	5460470K		Motor Assembly (DLV7331/7335-CKE/CKE B)	TD00532	1	5460487A
10	Spring Plate	TV00961	1	5460474K		Motor Assembly (DLV7331/7335-BKE)	TD02225	1	5460487B
11	Clutch Spring (DLV7321/7325)	TV00034	1	5460431K	29	Front Cover	TV00088	1	5460434K
12	Clutch Spring (DLV7331/7335)	TV00035	1	5460462K	30	Yoke Assembly	TD01918	1	5460267K
13	Steel Ball 2.38mm DIA.	CP20000	2	5462783K	31	Rotor Assembly (DLV7321/7325)	TD00557	1	5460203A
14	Bit Holder Assembly (DLV7321/7325)	TD02228	1	5460491A		Rotor Assembly (DLV7331/7335)	TD00558	1	5460488A
15	Steel Ball 3mm dia (DLV7321/7325)	TD02328	1	5460492A	32	Assembling Spring (CKE type)	TV00031	2	5460435K
16	Steel Ball 3.96mm dia (DLV7331/7335)	TP15767	2	5462780K		Assembling Spring (CKE B/BKE type)	TV00031	1	5460435K
17	Guide Sleeve	CP01181	2	5462704K	33	Assembling Spring (CKE B/BKE type)	TV00566	1	5469608K
18	Pilot Rod (A) 1.6mm DIA.-42mm	TV00328	1	5460243K	34	Shim	TV00335	1	5460733K
19	Collar (DLV7331/7335)	TV00080	1	5462174K	35	Shim	TV00496	1	5460701K
20	Washer	TV00042	1	5460461K	36	Ball Bearing	TV00068	1	5460211K
21	Cam (DLV7321/7325)	TV00058	1	5460266K	37	Side Plate (CKE type)	TV00063	1	5460216K
22	Cam (DLV7331/7335)	TV00043	2	5460459K		Side Plate (CKE B/BKE type)	TV00863	1	5460591K
23	Idle Gear (A) 15 tooth (DLV7321/7325)	TV00014	1	5460234K	38	End Cover	TV00009	1	5460214K
24	Idle Gear (A) 18 tooth (DLV7331/7335)	TV00015	1	5460458K	39	Brush Assembly	TD00586	2	5460217K
25	Gear Base (A) Assembly 15 tooth (DLV7321/7325)	TD00544	1	5460279A	40	Tapping Screw M2x4mm	TV00500	2	5460702K
26	Gear Base (A) Assembly 12 tooth (DLV7331/7335)	TV00002	3	5460224K	41	Brush Spring	TV00086	2	5460218K
27	Gear Base (B) Assembly 15 tooth (DLV7321/7325)	TV00636	3	5460456K	42	Shielded Plate (DLV7325/7335-CKE)	TD02109	1	5460489A
28	Gear Base (B) Assembly 12 tooth (DLV7331/7335)	TD00545	1	5460280A		Shielded Plate (DLV7325/7335-CKE B/BKE)	TD02217	1	5460489B
29		TD01792	1	5460452A	43	Tube (DLV7325/7335)	TV00642	1	5460899K
30					44	Nozzle (DLV7325/7335)	TV00826	1	5460321K
31					45	Bush (DLV7321/7331)	TV00929	2	5460424K
32					46	Spring	TV00333	1	5460433K
33					47	Trigger (CKE/CKE B type)	TV00517	1	5460427K
34						Trigger (BKE type)	TV00610	1	5460572K
35					48	Roller Pin 2mm DIA.-15.8mm	CO08854	1	5460705K
36					49	Pilot	TV00074	1	5460246K
37					50	Pilot Spring	TV00326	1	5460247K
38					51	Tapping Screw M2.3x12mm	TV00511	2	5460710K
39					52	Micro Switch	TV00199	1	5462172K
40					53	Screw M3x8mm	TV00515	2	5460711K
41					54	Toothed Lock Washer	TV00516	2	5460712K
42					55	Switch Plate	TV00048	1	5460613K
43					56	Change-Over Switch	TV00030	1	5462190K
44					57	Change-Over Switch Rocker	TV00258	1	5462195K
45					58	Micro Switch	TV00283	1	5462309K
46					59	Frame (A) (CKE/CKE B type)	TD01787	1	5460416K
47						Frame (B) (CKE/CKE B type)			
48						Frame (A) (BKE type)	TD01791	1	5460571K
49						Frame (B) (BKE type)			
50					60	Name Plate			
51					61	Tapping Screw M2.5x12mm	TV00518	3	5460703K
52					62	Rating Plate			
53					63	Lifting Hook Assembly	TD01927	1	5460426K
54					64	Cord Assembly (CKE type)	TD01795	1	5460249K
55						Cord Assembly (CKE B type)	TD02356	1	5469610K
56						Cord Assembly (BKE type)	TD01793	1	5460569K
57					65	Cord (CKE type)	TD01795	1	5460249K
58						Cord (CKE B type)	TD02273	1	5469604K
59						Cord (BKE type)	TD02209	1	5460569K
60					66	Plug (CKE type)	TV00571	1	5460250K
61						Plug (CKE B/BKE TYPE)	TV00862	1	5469605K
62					67	Packing (DLV7325/7335)	TV00546	1	5460432K
63					68	Vacuum Cap (1) (DLV7325/7335-CKE/CKE B)	TV00969	1	5460483K
64						Vacuum Cap (2) (DLV7325/7335-BKE)	TV00995	1	5460553K
65					69	Filter (DLV7325/7335)	TV00827	1	5460479K
66					70	Stop Ring (DLV7325/7335)	TV00583	1	5460484K
67					71	Spring (DLV7325/7335)	TV00972	1	5460478K
68					72	Moving Sleeve (DLV7325/7335)	TV00971	1	5460477K
69					73	O-Ring (DLV7325/7335)	TV00974	1	5460480K
70					74	Vacuum Cap (2) (DLV7325/7335-CKE/CKE B)	TV00970	1	5460476K
71						Vacuum Cap (2) (DLV7325/7335-BKE)	TV00996	1	5460554K
72					75	Nut (2) (DLV7325/7335)	TV00823	1	5460317K
73					76	ESD Seal (BKE type)			

REVISIONS: c) FEB.22.2002

THIRD ANGLE DRAWING		NITTO KOHKI CO.,LTD.	
DIMENSION IN			
SCALE		DRAWING TITLE	PARTS LIST
DATE DEC.26.1988			
ORDER NO.		DLV7301/7305-CKE/CKE B/BKE	
APPROVED	CHECKED	DESIGNED	DRAWN
			DRG. NO. OW20347c