

delvo

ELECTRIC SCREW-DRIVER

DLV7321-CME/CME B(6P BIT-EARTH)/BME
 DLV7331-CME/CME B(6P BIT-EARTH)/BME
 DLV7325-CME/CME B(6P BIT-EARTH)/BME
 DLV7335-CME/CME B(6P BIT-EARTH)/BME

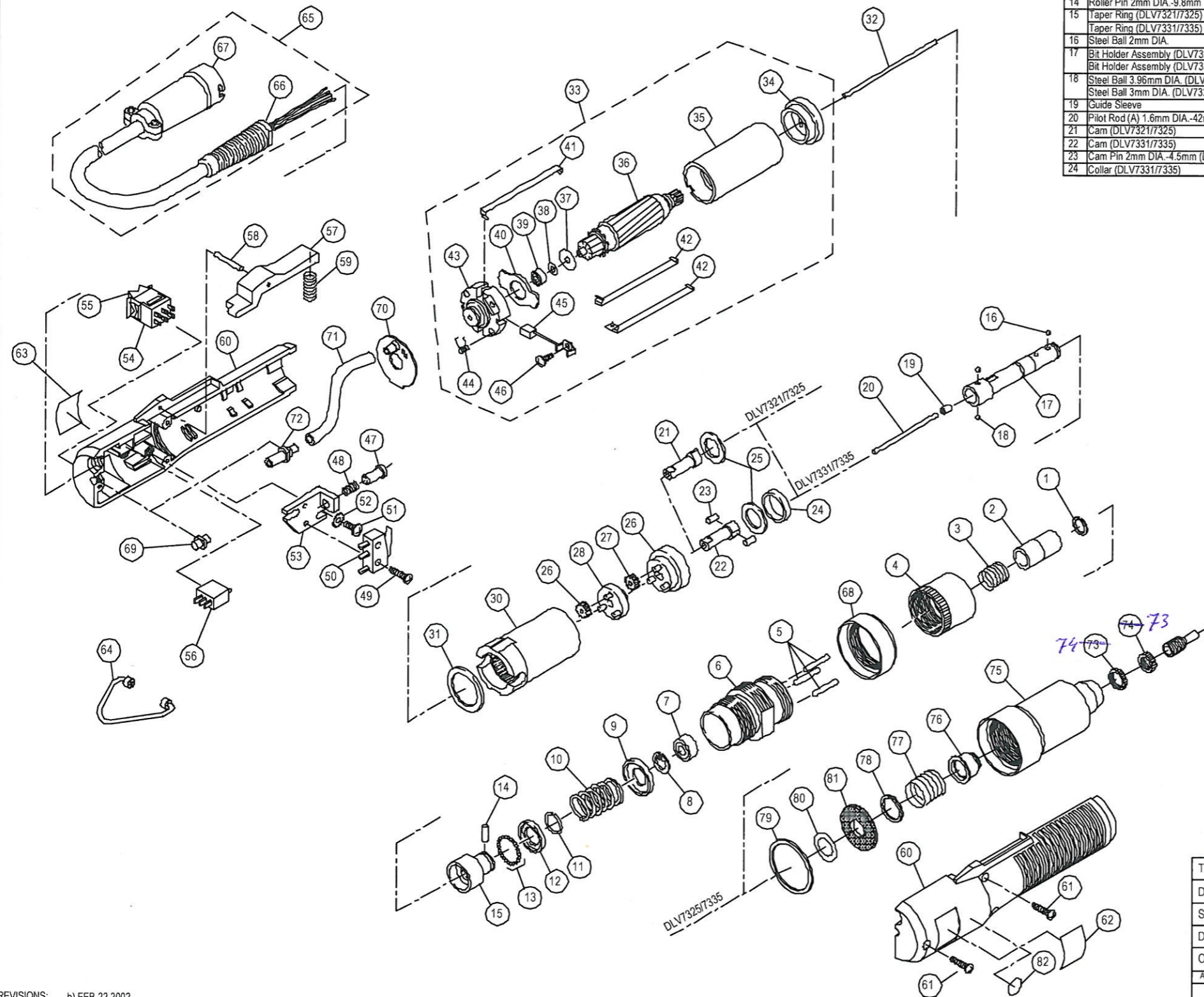

No.	Parts Name	Parts No.	Qty	(Parts No.)	No.	Parts Name	Parts No.	Qty	(Parts No.)
1	Stop Ring	TV00334	1	5460134K	25	Washer	TV00058	1	5460266K
2	Holder Clamp	TV00090	1	5460422K	26	Gear Base (A) Assembly	TD00544	1	5460279A
3	Holder Spring	TV00331	1	5460133K		Gear Base (B) Assembly 12tooth (DLV7331/7335)	TD01792	1	5460452A
4	Spring Adjusting Ring	TV00055	1	5460417K	27	Idle Gear (A) 15tooth (DLV7321/7325)	TV00002	3	5460224K
5	Roller Pin 2mm DIA.-17.8mm (DLV7331/7335)	TV00109	3	5462735K		Idle Gear (A) 18tooth (DLV7321/7325)	TV00636	3	5460456K
	Roller Pin 2mm DIA.-19.8mm (DLV7321/7325)	TV00510	3	5460753K	28	Gear Base (B) Assembly 15tooth (DLV7321/7325)	TD00545	1	5460280A
6	Nose Nut (CME type)	TV00045	1	5460411K	29	Idle Gear (B) 15tooth (DLV7321/7325)	TV00003	3	5460408K
	Nose Nut Assembly (CME B/BME type)	TD02072	1	5460411A		Idle Gear (B) 18tooth (DLV7331/7335)	TV00004	3	5460409K
7	Ball Bearing (CME type)	TV00509	1	5460233K	30	Gear Case 45tooth (DLV7321/7325)	TV00028	1	5460281K
8	Stop Ring	TV00091	1	5460708K		Gear Case 48tooth (DLV7331/7335)	TV00029	1	5460282K
9	Spring Plate	TV00054	1	5460474K	31	Spacer	TV00102	1	5460440K
10	Clutch Spring (DLV7321/7325)	TV00034	1	5460431K	32	Pilot Rod 1.6mm DIA.-61.5mm	TV00077	1	5460441K
	Clutch Spring (DLV7331/7335)	TV00035	1	5460462K	33	Motor Assembly (DLV7321/7325-CME B/BME)	TD02210	1	5460486B
11	Stop Ring	TV00050	1	5460238K		Motor Assembly (DLV7321/7325-CME)	TD00531	1	5460486A
12	Plate	TV00057	1	5460237K		Motor Assembly (DLV7331/7335-CME B/BME)	TD02225	1	5460487B
13	Steel Ball 2mm DIA.	TV00121	2	5462703K		Motor Assembly (DLV7331/7335-CME)	TD00532	1	5460487A
14	Roller Pin 2mm DIA.-9.8mm	TV00337	1	5460709K	34	Front Cover	TV00088	1	5460434K
15	Taper Ring (DLV7321/7325)	TV00071	1	5460291K	35	Yoke Assembly	TD01918	1	5460267K
	Taper Ring (DLV7331/7335)	TV00072	1	5460292K	36	Rotor Assembly (DLV7321/7325)	TD00557	1	5460203A
16	Steel Ball 2mm DIA.	TV00121	19	5462703K		Rotor Assembly (DLV7331/7335)	TD00558	1	5460488A
17	Bit Holder Assembly (DLV7321/7325)	TD00539	1	5460410A	37	Shim	TV00335	1	5460733K
	Bit Holder Assembly (DLV7331/7335)	TD00540	1	5460463A	38	Shim	TV00096	2	5460701K
18	Steel Ball 3.96mm DIA. (DLV7331/7335)	CP01181	2	5462704K	39	Ball Bearing	TV00068	1	5460211K
	Steel Ball 3mm DIA. (DLV7321/7325)	TP15767	2	5462780K	40	Side Plate (CME B/BME type)	TV00863	1	5460591K
19	Guide Sleeve	TV00328	1	5460243K		Side Plate (CME type)	TV00063	1	5460216K
20	Pilot Rod (A) 1.6mm DIA.-42mm	TV00080	1	5462174K	41	Assembling Spring (CME B/BME type)	TV00031	1	5460435K
21	Cam (DLV7321/7325)	TV00014	1	5460234K		Assembling Spring (CME type)	TV00031	2	5460435K
22	Cam (DLV7331/7335)	TV00015	1	5460458K	42	Assembling Spring (CME B/BME type)	TV00566	1	5469608K
23	Cam Pin 2mm DIA.-4.5mm (DLV7331/7335)	TV00043	2	5460459K	43	End Cover	TV00009	1	5460214K
24	Collar (DLV7331/7335)	TV00042	1	5460461K	44	Brush Spring	TV00086	2	5460218K
					45	Brush Assembly	TD00586	2	5460217K
					46	Tapping Screw M2x4mm	TV00500	2	5460702K
					47	Pilot	TV00074	1	5460246K
					48	Pilot Spring	TV00326	1	5460247K
					49	Tapping Screw	TV00511	1	5460710K
					50	Micro Switch	TV00199	1	5462172K
					51	Screw M3x8mm	TV00515	2	5460711K
					52	Toothed Lock Washer	TV00516	2	5460712K
					53	Switch Plate	TV00048	1	5460613K
					54	Change-Over Switch	TV00030	1	5462190K
					55	Change-Over Switch Rocker	TV00258	1	5462195K
					56	Micro Switch	TV00283	1	5462309K
					57	Trigger (BME type)	TV00610	1	5460572K
						Trigger (CME/CME B type)	TV00517	1	5460427K
					58	Roller Pin 2mm DIA.-15.8mm	CQ08854	1	5460705K
					59	Spring	TV00333	1	5460433K
					60	Frame (A) (BME type)	TD01791	1	5460571K
						Frame (B) (BME type)			
						Frame (A) (CME/CME B type)	TD01787	1	5460416K
						Frame (B) (CME/CME B type)			
					61	Tapping Screw M2.5x12mm	TV00518	3	5460703K
					62	Rating Plate			
					63	Name Plate			
					64	Lifting Hook Assembly	TD01927	1	5460426K
					65	Cord Assembly (BME type)	TD01793	1	5460569K
						Cord Assembly (CME B type)	TD02356	1	5469610K
						Cord Assembly (CME type)	TD02163	1	
					66	Cord (BME type)	TD02209	1	
						Cord (CME B type)	TD02273	1	5469604K
						Cord (CME type)	TD01795	1	5460249K
					67	Plug (CME B/BME type)	TV00862	1	5469605K
						Plug (CME type)	TV00571	1	5460250K
					68	Coupling (DLV7321/7331)	TV00011	1	5460419K
					69	Bush (DLV7321/7331)	TV00929	1	5460424K
					70	Shielded Plate (DLV7325/7335-CME B/BME)	TD02217	1	5460489B
						Shielded Plate (DLV7325/7335-CME)	TD02109	1	5460489A
					71	Tube (DLV7325/7335)	TV00642	1	5460899K
					72	Nozzle (DLV7325/7335)	TV00826	1	5460321K
					73	Nut (2) (DLV7325/7335)	TV00823	1	5460317K
					74	Nut (1) (DLV7325/7335)	TV00822	1	5460316K
					75	Vacuum Cap (DLV7325/7335-BME)	TV00865	1	5460573K
						Vacuum Cap (DLV7325/7335-CME/CME B)	TV00818	1	5460412K
					76	Moving Sleeve (DLV7325/7335)	TV00819	1	5460442K
					77	Spring (DLV7325/7335)	TV00820	1	5460315K
					78	Stop Ring (DLV7325/7335)	TV00329	1	5460713K
					79	Packing (DLV7325/7335)	TV00546	1	5460432K
					80	Liner (DLV7325/7335)	TV00828	1	5460469K
					81	Filter (DLV7325/7335)	TV00827	1	5460466K
					82	ESD Seal (BME TYPE)		1	

REVISIONS: b) FEB,22,2002

THIRD ANGLE DRAWING		NITTO KOHKI CO., LTD.	
DIMENSION IN		DRAWING TITLE	PARTS LIST
SCALE			
DATE OCT,30,1992		DLV73017/305-CME/CME B(6P BIT-EARTH)/BME	
ORDER NO.			
APPROVED	CHECKED	DESIGNED	DRAWN
			DRG NO. OW20454b